

**THE 30TH
COLUMBIA UNIVERSITY
GRADUATE STUDENT CONFERENCE
ON EAST ASIA**

OCT 18-19, 2024



Program



Guest Registration Info

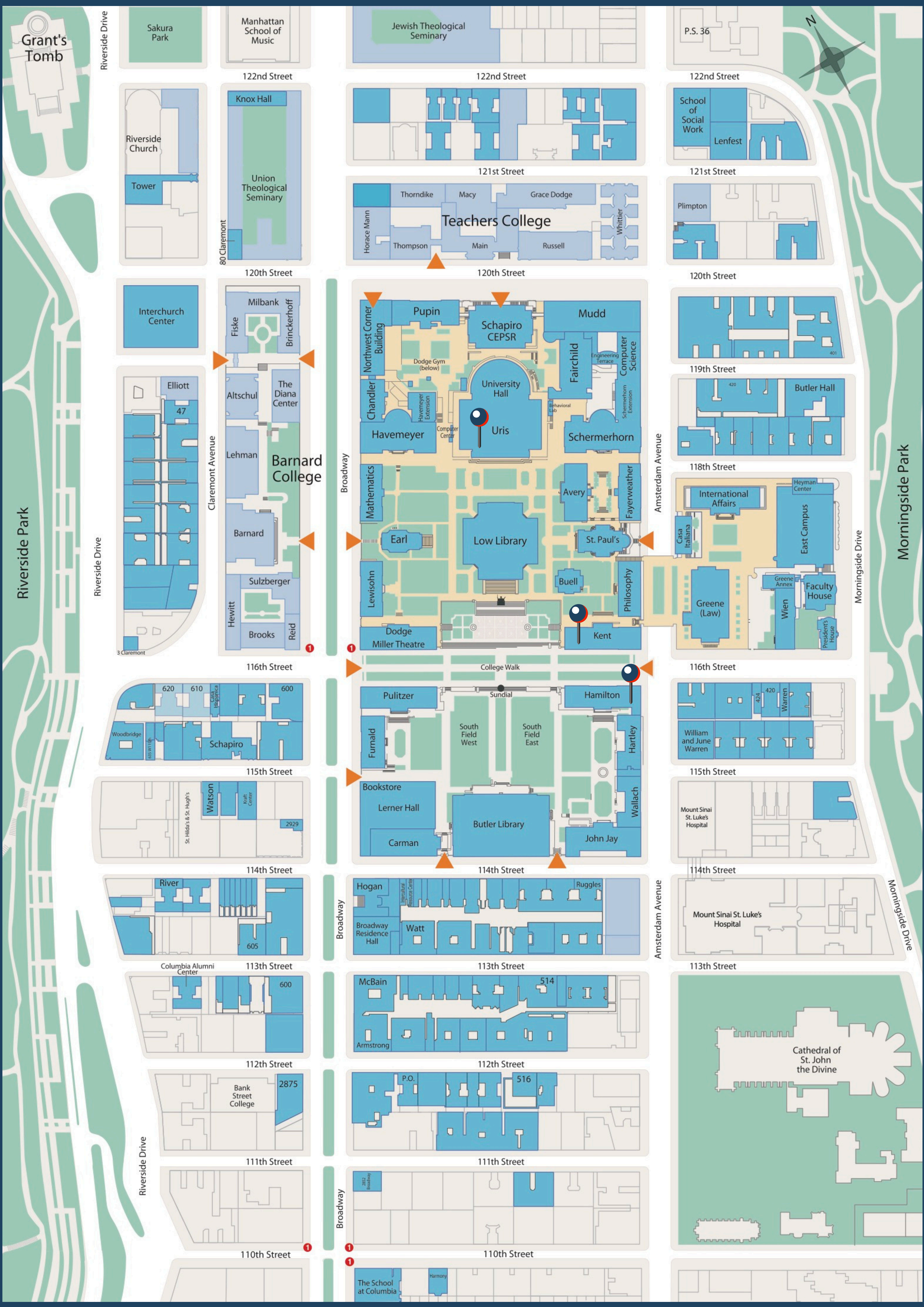

Grant's Tomb

Riverside Drive

Sakura Park

Manhattan School of Music

Jewish Theological Seminary

P.S. 36



122nd Street

122nd Street

122nd Street

Riverside Church

Tower

Knox Hall
Union Theological Seminary

Teachers College

School of Social Work
Lenfest

121st Street

121st Street

Thorndike Macy Grace Dodge
Horace Mann Thompson Main Russell Whittier

Plimpton

120th Street

120th Street

120th Street

Interchurch Center

Fiske Milbank Brinckerhoff

Pupin Schapiro CEPSP Mudd
Northwest Corner Building Dodge Gym (below) University Hall Fairchild
Chandler Havemeyer Computer Center Schermerhorn
Earl Low Library St. Paul's
Lewisohn Mathematics Avery Fayerweather
Miller Theatre Kent

Butler Hall

Barnard College

Broadway

Amsterdam Avenue

Butler Hall

Elliott 47

Altschul The Diana Center
Lehman

International Affairs Heyman Center
East Campus
Greene (Law) Faculty House
Wien President's House

International Affairs Heyman Center
East Campus
Greene (Law) Faculty House
Wien President's House

119th Street

119th Street

119th Street

Hewitt Brooks Reid
Sulzberger Barnard

Hewitt Brooks Reid
Sulzberger Barnard

Mathematics Avery Fayerweather
Buell Philosophy
Dodge Miller Theatre Kent

International Affairs Heyman Center
East Campus
Greene (Law) Faculty House
Wien President's House

116th Street

116th Street

116th Street

Woodbridge Schapiro
620 610 600

Pulitzer Sundial Hamilton
Furnald South Field West South Field East Hartley
Bookstore Lerner Hall Butler Library Wallach
Carman John Jay

William and June Warren

115th Street

115th Street

115th Street

Watson Kraft Center
St. Hilda's & St. Hugh's 2929

Hogan Ruggles
Broadway Residence Hall Watt

Mount Sinai St. Luke's Hospital

114th Street

114th Street

114th Street

River 605

Hogan Ruggles
Broadway Residence Hall Watt

Mount Sinai St. Luke's Hospital

113th Street

113th Street

113th Street

Columbia Alumni Center 600

McBain 514
Armstrong

Cathedral of St. John the Divine

112th Street

112th Street

112th Street

Bank Street College 2875

P.O. 516

Cathedral of St. John the Divine

111th Street

111th Street

111th Street

Bank Street College 2875

P.O. 516

Cathedral of St. John the Divine

110th Street

110th Street

110th Street

The School at Columbia

The School at Columbia Harmony

Cathedral of St. John the Divine

Riverside Park

Riverside Drive

Morningside Drive

Morningside Park

COLUMBIA UNIVERSITY IN THE CITY OF NEW YORK

CAMPUS SECTION

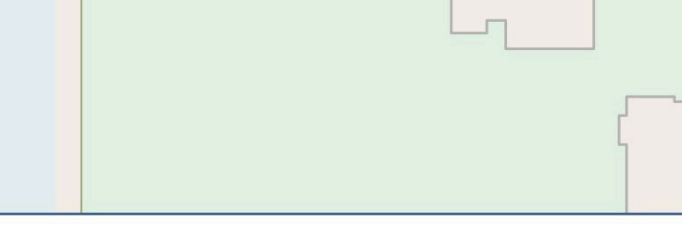
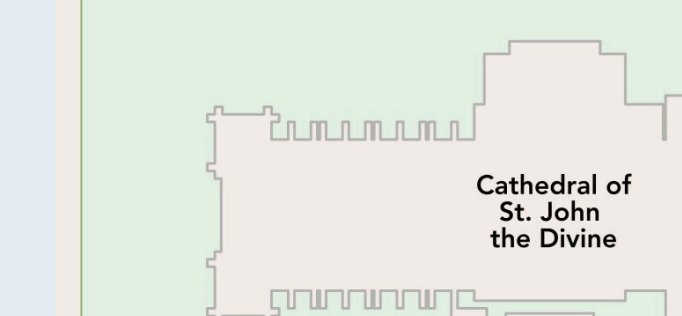
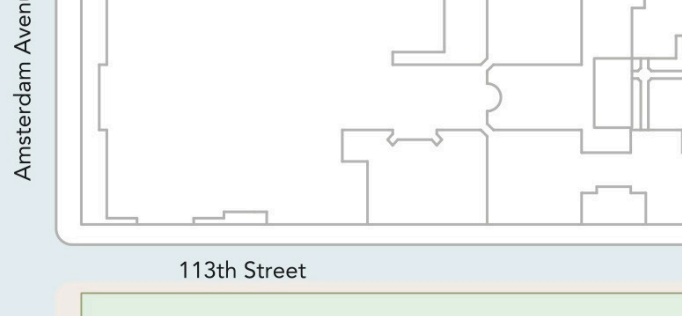
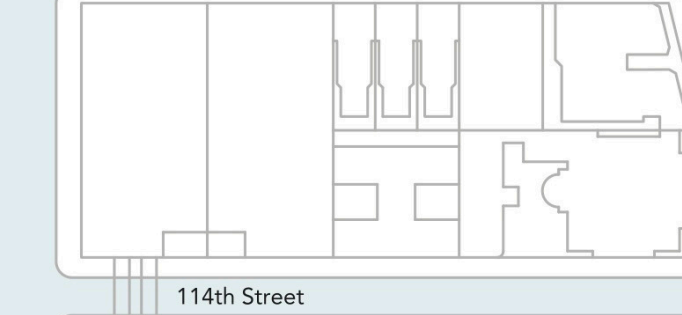
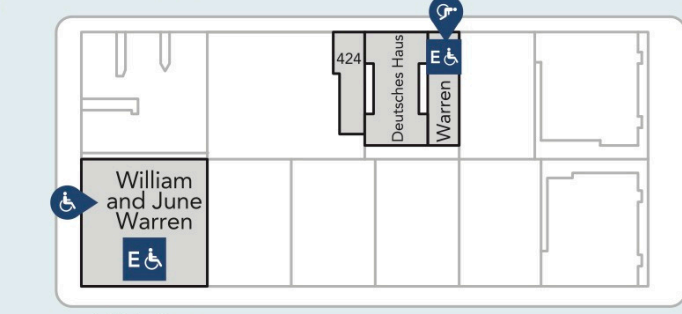
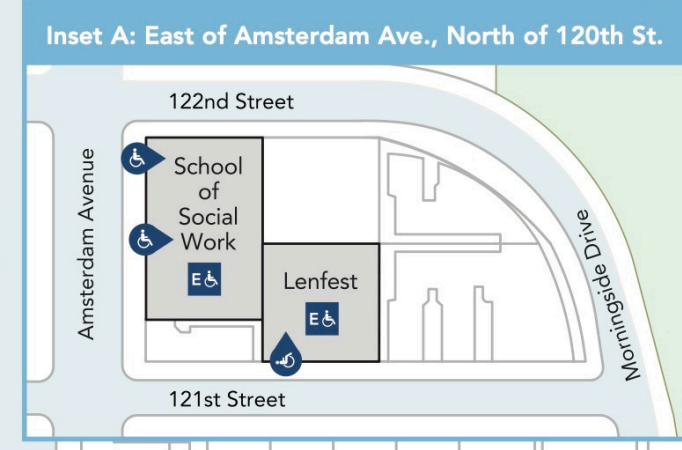
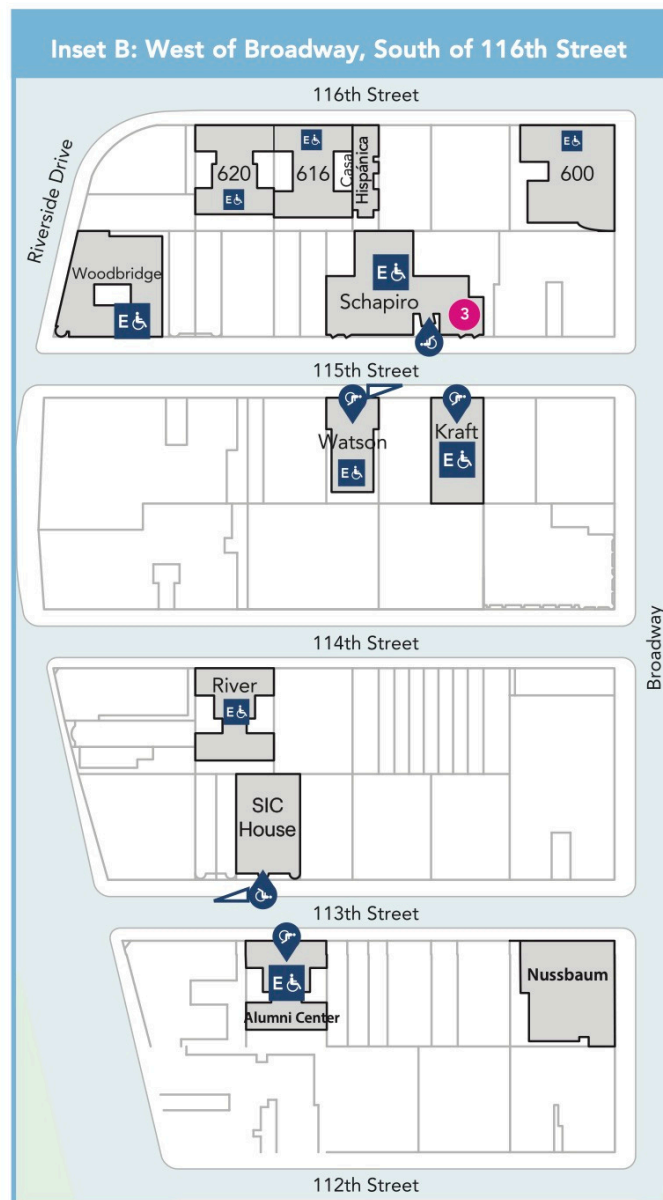
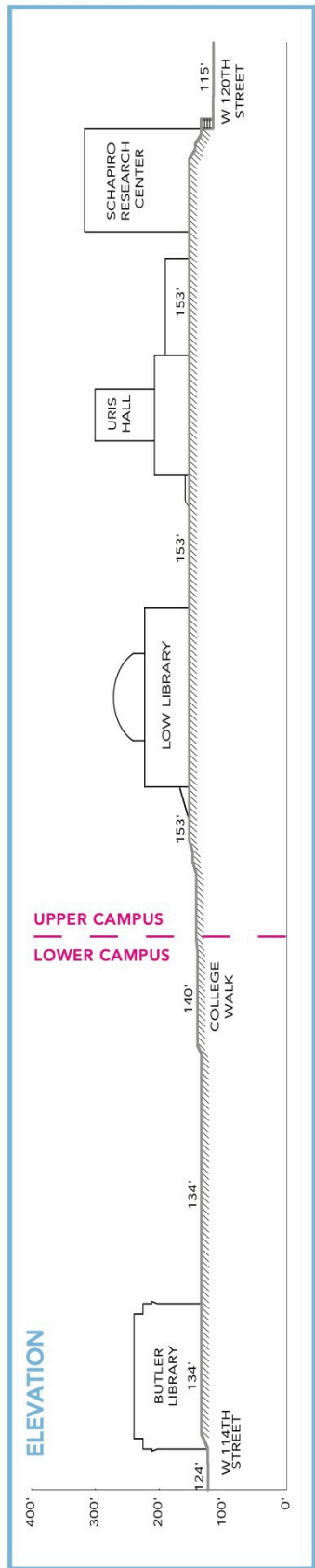

UPPER CAMPUS
LOWER CAMPUS

MAP KEY

- Accessible Campus Entrance
- Accessible Building Entrance
- Building Elevator
- Ramp
- Accessible Campus Route
- Interbuilding Access (interior)
Refer to reverse side of map for additional information; may require pre-authorization
- Grass
- Upper Campus
- Accessible Building Entrance Requiring Columbia University Identification (CUID) swipe access at all times—
Prior authorization required
- Restricted Access Elevator—
Prior authorization or assistance from Public Safety required
- Wheelchair Lift—
Prior authorization or assistance from Public Safety required
- Venue w/number—refer to other side for venue information
- Visitor information

ACCESSIBLE CAMPUS ROUTE INFORMATION

- To access Upper Campus:
- From 116th Street and Broadway, use Dodge elevator located on College Walk, west of Low Plaza
 - Via Kent Hall, enter Kent through College Walk entrance and exit building on 3rd floor (accessible during business hours Monday–Friday; call 212-854-2797 to confirm hours)
 - Via Schapiro/CEPSR Hall, enter 120th Street entrance of Schapiro/CEPSR Hall between Broadway and Amsterdam Avenue and exit building on 4th floor (accessible during business hours Monday–Friday; call 212-854-2797 to confirm hours)
 - Via Northwest Corner Building (NWC), enter NWC on 120th Street and Broadway and exit building on 4th floor
- To access buildings located on lower campus—Butler Library, Carman, Furnald, John Jay, Hamilton Hall, Hartley-Wallach, Pulitzer (Journalism), and Lerner Hall:
- From College Walk, use ramp adjacent to Pulitzer (Journalism) or ramp adjacent to Hamilton Hall
 - From 115th Street and Broadway, use ramp adjacent to Lerner Hall

SCHEDULE AT A GLANCE

1:00 PM - 4:00 PM

17
OCT

REGISTRATION

KENT HALL 624

9:00 AM - 9:45 AM

18
OCT

REGISTRATION

KENT HALL 403

10:00 AM - 10:15 AM

OPENING REMARKS

MICHAEL COMO, URIS 142

10:15 AM - 11:15 AM

KEYNOTE SPEECH

REBECCA KARL, URIS 142

11:30 AM - 1 PM

LUNCH

KENT HALL 403

1 PM - 3 PM / 3:15 PM - 5:15 PM

PANELS

HAMILTON HALL

5:30 PM

DINNER

KENT HALL 403

COLUMBIA GRADCON 2024



SCHEDULE AT A GLANCE

19
OCT

9:00 AM – 10 AM

COFFEE, BREAKFAST, CHAT

KENT HALL 403

10:15 AM – 12:15 PM

PANELS

HAMILTON HALL

12:30 PM – 1:45 PM

LUNCH

KENT HALL 403

2 PM – 4 PM

PANELS

HAMILTON HALL

9 PM – 11 PM

CLOSING CELEBRATION

LOCATION TO BE ANNOUNCED

COLUMBIA GRADCON 2024



SCHEDULE FOR PANELS

1 PM - 3 PM

18
OCT



PANEL A HAMILTON 516

YIXUAN LI (NEW YORK UNIVERSITY)

"MAO ZEDONG'S SWIMMING: BODY POLITICS IN CHINA STATE NEWSREELS OF THE SOCIALIST ERA"

FEI DENG (UNIVERSITY OF HONG KONG)

"HOW SPACE TELL STORIES: REDISCOVERING THE UNTOLD LIFE OF CHINESE AMERICAN WOMAN SUFFRAGIST MABLE PING HUA LEE (1897-1966)"

ZIQIAN ZHENG (COLUMBIA UNIVERSITY)

"ECONOMIC PRAGMATISM BEHIND "SOCIALIST COMRADESHIP": A HISTORY OF THE SINO-POLISH JOINT STOCK SHIPPING COMPANY, 1949-1961"

DISCUSSANT: REBECCA KARL

PANEL B HAMILTON 703

UNDER ONE SKY: CROSS-CULTURAL EXPLORATIONS OF TIAN IN EAST ASIA

NIJUN ZHANG (UNIVERSITY OF PITTSBURGH)

"A MEETING PLACE - THE JUXTAPOSITION OF INDIAN NAVAGRAHA AND HAN CHINESE DIVINATION ON THE NINE CELESTIAL PALACES FATE CALCULATION METHOD IN DUNHUANG MANUSCRIPTS"

JIMAO ZHUOMA (NORTHWEST UNIVERSITY)

"THE SOLAR ECLIPSE ALGORITHM OF BEE D'URYA DKAR PO AND ITS COMPUTATIONAL ACCURACY"

YIXIN LIANG (WUHAN UNIVERSITY)

"THE DEITY (神祇) SYSTEM IN THE COSMIC SCHEMA OF WUJI (五紀) FROM THE TSINGHUA BAMBOO SLIPS (清華簡)"

HANG XIONG (RENMIN UNIVERSITY)

"THE QING COURT'S CALENDAR-ISSUING ACTIVITIES IN TIBET AS SEEN IN THE NEWLY RELEASED ARCHIVAL DOCUMENTS OF TIBET DURING THE QING DYNASTY - TAKING THE ARCHIVAL DOCUMENTS INVOLVING THE SHI XIAN LI CALENDER (時憲曆) AND THE YI TI JIU HU SHI (一體救護事) FROM THE SELECTED ARCHIVES OF TIBET DURING THE QING DYNASTY (清代西藏地方檔案選編)" [VIRTUAL]

DISCUSSANT: DOMINIQUE TOWNSEND



COLUMBIA GRADCON 2024



SCHEDULE FOR PANELS

1 PM - 3 PM

18
OCT



PANEL C

HAMILTON 411

JUSUNG LEE (YALE UNIVERSITY)

"EVOLUTION OF SOCIAL ENGAGEMENT: UNVEILING THE DYNAMICS OF MODERN KOREAN BUDDHISM FROM THE JAPANESE COLONIAL PERIOD TO DEMOCRATIZATION"

WENJIN FANG (DUKE UNIVERSITY)

"TEMPLE DESTRUCTION IN EARLY 20TH CENTURY CHINA: A CASE STUDY OF THE BA COUNTY, 1900-1936"

WEILING KONG (UNIVERSITY OF NOTRE DAME)

"PUBLIC VIRTUE VS. INDIVIDUAL VIRTUE: A COMPARATIVE ANALYSIS OF CATHOLIC AND NEO-CONFUCIAN SEXUAL ETHICS IN THE LATE MING PERIOD"

DISCUSSANT: NATALY SHAHAF

PANEL D

HAMILTON 402

THE RULES OF FAITH: FLEXIBILITY AND EVOLUTIONS OF THE STATE AND "CHURCH" RELATIONSHIP IN MIDDLE PERIOD CHINA

SHUYANG LI (YALE UNIVERSITY)

"FROM CLAN TO EMPIRE: THE RISE AND FALL OF THE LEGITIMACY OF THE TUTAN ZHAI 塗炭齋 RITUAL FROM LIU SONG (420-479) TO THE EARLY TANG"

XIAOYUE LIU (COLUMBIA UNIVERSITY)

"PATRONAGE AND POWER: DAOIST SECTS AND STATE RELATIONS FROM THE SOUTHERN SONG TO THE YUAN DYNASTY (1127-1368)"

XINZHI LIN (COLUMBIA UNIVERSITY)

"REVERENCE AND RULE: BUDDHA'S RELICS AT THE HEART OF EARLY SONG DYNASTY STATECRAFT"

ZHICHEN ZHOU (PRINCETON UNIVERSITY)

"BECOMING "DUNHUANG PEOPLE": ANCESTOR WORSHIP AND IDENTITY FORMATION IN MOGAO CAVE 231"

DISCUSSANT: MACKENZIE FOX



COLUMBIA GRADCON 2024



SCHEDULE FOR PANELS

3:15 PM – 5:15 PM

18
OCT



PANEL A HAMILTON 516

RUIXIN WEI (GOETHE UNIVERSITY FRANKFURT)

“TEMPORALITY AND TRANSNATIONAL MEMORIES: THE ROLE OF CHILDREN IN KOREAN CHINESE TRANSNATIONAL FAMILIES”

TORUNIKA ROY (JAWAHARLAL NEHRU UNIVERSITY)

“COLD WAR AND POPULATION CONTROL: THE INTERSECTION OF AMERICAN CONTRACEPTIVE TECHNOLOGY AND WOMEN'S HEALTH IN SOUTH KOREA”
[VIRTUAL]

INKYEONG CHUNG (UNIVERSITY OF PENNSYLVANIA)

“COMEDIC ANALYSIS OF KIM YOUNG-HA'S "OPPA IS BACK" (2004)”

QIHAO LIANG (UNIVERSITY OF MICHIGAN)

DIVERGENT PATHS TO GLOBAL CITIZENSHIP: EXTERNAL CO-ETHNIC MEMBERSHIP, TRANSBORDER MOBILITY, AND ONWARD MIGRATION AMONG CROSS-TAIWAN STRAIT MIGRANTS

DISCUSSANT: RUTH BARRACLOUGH

PANEL B HAMILTON 703

WOMEN IN ACTION AND MEMORY IN MEDIEVAL JAPAN (12CE TO EARLY 17CE)

YUMI KODAMA (UNIVERSITY OF PENNSYLVANIA)

“WOMEN'S SIEGE OF OSAKA (1614-1615)”

JIAYIN YUAN (UNIVERSITY OF PENNSYLVANIA)

“TIL DEATH DO US PART: WAR MEMORIES OF FEMALE TAIRA SURVIVORS IN HEIKE KINDACHI ZŌSHI”

HE (SELINA) WANG (COLUMBIA UNIVERSITY)

“THE ANECDOTES OF WINNING WOMEN: STRENGTH, SKILLS, SARCASM, AND SUPERNATURALS IN KONJAKU MONOGATARISHŪ”

JULIE MORRIS (UCLA ' 23)

“ARTISTIC LIBERTIES: PRESERVATION, POLITICS, OR PRIDE IN RYŌJIN HISHŌ”

DISCUSSANT: BRYAN LOWE



COLUMBIA GRADCON 2024



SCHEDULE FOR PANELS

10:15 AM - 12:15 PM

19
OCT



PANEL A HAMILTON 602

TIEN YI LI (MASSACHUSETTS INSTITUTE OF TECHNOLOGY)

"THE SHANGHAI MUNICIPAL PAPER-MAKING SAME-TRADE ASSOCIATION AND HISTORY OF TECHNOLOGIES"

EVELYN EMERY (UNIVERSITY OF COLORADO BOULDER)

"SHIBUKAWA HARUMI AND ECLIPSE PREDICTION IN EDO PERIOD JAPAN"

XIAO LI (RENMIN UNIVERSITY)

"RADIO STATIONS AND INFORMATION SPACE IN MODERN CHINA FROM THE PERSPECTIVE OF SPATIAL HISTORY: A CASE STUDY OF THE 1930S"

JIANXUE CHEN (UNIVERSITY OF CALIFORNIA, BERKELEY)

"RETUNING BETWEEN THE NATION AND THE SELF: THE RADIO SOUNDSCAPE RECONSTRUCTED BY EILEEN CHANG"

DISCUSSANT: YINGCHUAN YANG

PANEL B HAMILTON 603

PRECARITY AFTER THE JAPANESE EMPIRE: MOVEMENTS, MOBILITIES, AND MEMORIES

SHUNSUKE TANAKA (THE UNIVERSITY OF TOKYO)

"RE-EXAMINING CIVIC POLITICS THROUGH TAKABATAKE'S CONTRIBUTIONS: INVESTIGATING POST-WAR SOCIAL MOVEMENTS AND DIRECT ACTION IN JAPAN"

YOUYUN YE (THE UNIVERSITY OF TOKYO)

"DECOLONIZING COLONIAL LEGACY: REVIVAL OF SHINTO SHRINES IN CONTEMPORARY TAIWAN"

YONGKANG CHEN (DUKE UNIVERSITY)

"ISLANDS OF PRECARITY: SUTURING RESISTANCE, HOPE, AND DELUSION IN MEDORUMA SHUN'S DROPLETS AND TAKAMINE GŌ'S UNTAMAGIRŪ"

HECHEN LIU (DUKE UNIVERSITY)

"WORKERS, MINERALS, AND PLANTS: WASTIZATION AND ECOLOGICAL ASSEMBLAGES OF WASTES IN FUSHUN, CHINA"

DISCUSSANT: TIANYUAN HUANG



COLUMBIA GRADCON 2024



SCHEDULE FOR PANELS

10:15 AM - 12:15 PM

19
OCT



PANEL C HAMILTON 702

YI HUANG (UNC CHAPEL HILL)

"FAITH AGAINST THE FLOW: THE ROLE OF 19TH-CENTURY MISSIONARIES IN THE OPIUM ABOLITION MOVEMENT IN CHINA, 1830-1872"

EKATERINA KOLOMYTSEVA (SHANGHAI UNIVERSITY)

"HISTORIC THREADS, MODERN WEAVES: RUSSIAN ORTHODOX CHURCHES IN SHANGHAI (1937 - PRESENT)"
[VIRTUAL]

ZELIN WANG (HARVARD UNIVERSITY)

"STRANGERS IN A STRANGE LAND: MENTAL ILLNESS IN EARLY JAPANESE SETTLEMENT COMMUNITIES IN MANCHURIA (1932-1938)"

DISCUSSANT: SAU-YI FONG

PANEL D HAMILTON 703

SKYLAR HOU (COLUMBIA UNIVERSITY)

"WHAT A GREAT TIME TO BE US: LEARNING MONGOLIAN IN THE PRESENT"

NAN NI (SOAS, UNIVERSITY OF LONDON)

"LETTERS OF LEGACY: THE SOGDIAN INFLUENCE ON OLD UYGHUR, MONGOLIAN AND MANCHU WRITING"

JIEYING LIN (SOUTHWEST JIAOTONG UNIVERSITY)

"THE OVERSEAS INFLUENCE OF THE ANCIENT CHINESE EMENDATION AND COMMENTARY TRADITION: MARGINALIA OF CHINESE CHARACTER-BASED LITERATURES IN ANCIENT VIETNAM" [VIRTUAL]

DISCUSSANT: ALBERT E. ERRICKSON



COLUMBIA GRADCON 2024



SCHEDULE FOR PANELS

2 PM - 4 PM

19
OCT



PANEL A HAMILTON 602

ZENGXIN WEN (TONGJI UNIVERSITY)

"THE TRAVELLING TECHNOLOGY OF TRANSPARENCY: GLASS CURTAIN WALLS IN POST-REFORM CHINA"

YIDI ZHENG (DUKE UNIVERSITY)

"5G EPIDEMIOLOGY": INVENTING SPATIOTEMPORAL OVERLAP IN DYNAMIC ZERO-COVID CHINA"

HUAXING WU (FUDAN UNIVERSITY)

SOUTHERN CROSSINGS ON THE PERIPHERY: NARRATOLOGY AND TRANSCULTURATION IN THE SINOSPHERE SINCE THE 1990S

LU CHEN (HONG KONG BAPTIST UNIVERSITY)

TOMBOY ON SCREEN: DISGUISE, REBELLION, AND TRANSGRESSION IN CHINESE CINEMATIC GENDER PORTRAYALS

DISCUSSANT: YING QIAN

PANEL B HAMILTON 603

RAISA STEBBINS (UNIVERSITY OF COLORADO - BOULDER)

"REALISM IS IN THE EYE OF THE BEHOLDER: ZEAMI, TERAYAMA, AND BETSUYAKU ON MAKING THEATRE"

ZIQI XU (UNIVERSITY OF EDINBURGH)

"MULTIFACETED SATELLITES: ART CURATORIAL MAPPING BETWEEN POETRY AND TECHNOLOGY"

TIANYI WANG (KYOTO UNIVERSITY/HEIDELBERG UNIVERSITY)

"REVITALIZATION OR ECLIPSE: EXAMINING NAOSHIMA'S DICHOTOMY THROUGH THE MATERIALITY OF LIGHT AT THE CHICHU ART MUSEUM"

WEI LIN TAN (HARVARD UNIVERSITY)

"THE QUEER FORCE OF NIKUDAN-KEI GEKIGA: HYPERMASCULINITY AND HOMOEROTICISM IN 1970S JAPANESE MALE-ORIENTED VISUAL CULTURE"

DISCUSSANT: TAKUYA TSUNODA



COLUMBIA GRADCON 2024



SCHEDULE FOR PANELS

2 PM - 4 PM

19
OCT



PANEL C HAMILTON 702

QINGYE WANG (YALE UNIVERSITY)

"OCEANIC PERSPECTIVE AND THE EMERGENCE OF MEDIA IN CHOUHAI TUBIAN (1562)"

YINUO JIN (STANFORD UNIVERSITY)

"ACTIVE COOPERATION AND LEGITIMATE TRANSGRESSION: YAN YONGHUA'S INTERACTIONS WITH THE COUPLE'S RETREAT GARDEN"

SHAN REN (UNIVERSITY OF OREGON)

"NARRATING ORTHODOXY IN KYOKUTEI BAKIN'S KAIKAN KYŌKI KYŌKAKUDEN"

BING BAI (HEIDELBERG UNIVERSITY)

"DEMYTHOLOGIZING A LITERATI IDEAL: NI ZAN'S ARTISTIC PRACTICE IN DAILY LIFE AND SOCIAL NETWORKS, 1306-1374"

DISCUSSANT: WEI SHANG

PANEL D HAMILTON 703

JUNGHWAN RYOO (INDEPENDENT SCHOLAR)

"THE SOUTHERNERS' DIASPORA IN THE SUI-TANG CAPITAL REGION"

YINGYUAN FAN (RENMIN UNIVERSITY/HARVARD UNIVERSITY)

"YANG WANLI'S LONG JOURNEY OF "ESCAPE": POLITICAL ECOLOGY AND INDIVIDUAL EXPERIENCE IN SOUTHERN SONG DYNASTY"

JOEY LOW (BRANDEIS UNIVERSITY)

"EXTORTION AND LABOR: CARTELIZATION OF THE CHINA-VIETNAM BORDERLANDS, 1475-1522"

JUNSUB EOM (COLUMBIA UNIVERSITY)

"PRESTIGE UNDER DOMINATION: QUALIFYING KORYŎ PRECEPTORS THROUGH YUAN PILGRIMAGES, 1259-1356"

DISCUSSANT: ROBERT HYMES



COLUMBIA GRADCON 2024



SPONSORSHIP

THANK YOU TO OUR SPONSORS:

THE DEPARTMENT OF EAST ASIAN LANGUAGES AND CULTURES

THE DONALD KEENE CENTER OF JAPANESE CULTURE

THE CENTER ON JAPANESE ECONOMY AND BUSINESS

THE WEATHERHEAD EAST ASIAN INSTITUTE

THE GRADUATE SCHOOL OF ARTS AND SCIENCES

THE INSTITUTE FOR COMPARATIVE LITERATURE AND SOCIETY

THE TANG CENTER FOR EARLY CHINA

THE ARTS AND SCIENCES GRADUATE COUNCIL

THE DEPARTMENT OF ANTHROPOLOGY

SCHOOL OF THE ARTS

DEPARTMENT
OF EAST ASIAN
LANGUAGES
& CULTURES



GRADUATE SCHOOL
OF ARTS AND SCIENCES
COLUMBIA UNIVERSITY



TANG CENTER FOR EARLY CHINA



Columbia Business School
Center on Japanese Economy
and Business



INSTITUTE FOR COMPARATIVE
LITERATURE AND SOCIETY
COLUMBIA UNIVERSITY



DONALD KEENE CENTER
of Japanese Culture



COLUMBIA UNIVERSITY
Weatherhead East Asian Institute



ARTS AND SCIENCES
GRADUATE COUNCIL

**COLUMBIA UNIVERSITY
SCHOOL OF THE ARTS**

DEPARTMENT OF ANTHROPOLOGY

COLUMBIA GRADCON 2024



**THE 30TH
COLUMBIA UNIVERSITY
GRADUATE STUDENT CONFERENCE
ON EAST ASIA**

OCT 18-19, 2024

DEPARTMENT
OF EAST ASIAN
LANGUAGES
& CULTURES